

Proposed Site Layout



bellarchitects
CREATIVE DESIGN : SUSTAINABLE APPROACH

Planning Act (NI) 2011 Causeway Coast and Glens Borough Council
GRANTED
Subject to Conditions (if any) as set out on
Decision form No. LA01/2020/0753/F
Date 01/06/2020

LA01/2020/0753

Planning Office RECEIVED
31 JUL 2020
File No.
Causeway Coast and Glens Borough Council

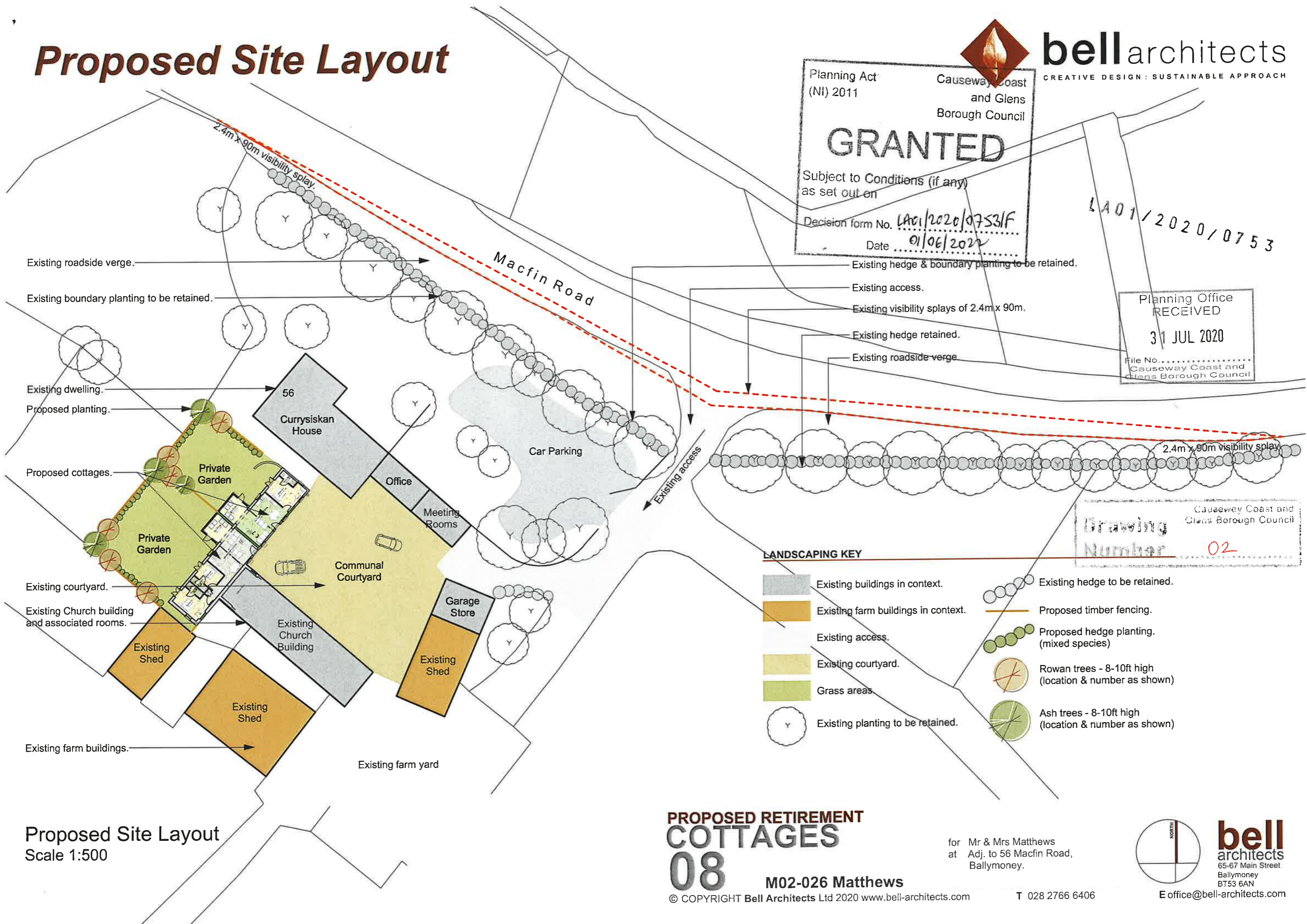

LANDSCAPING KEY

- Existing buildings in context.
- Existing farm buildings in context.
- Existing access.
- Existing courtyard.
- Grass areas.
- Existing planting to be retained.
- Existing hedge to be retained.
- Proposed timber fencing.
- Proposed hedge planting (mixed species).
- Rowan trees - 8-10ft high (location & number as shown).
- Ash trees - 8-10ft high (location & number as shown).

Drawing Number 02
Causeway Coast and Glens Borough Council

Proposed Site Layout
Scale 1:500

PROPOSED RETIREMENT COTTAGES
08

M02-026 Matthews

© COPYRIGHT Bell Architects Ltd 2020 www.bell-architects.com

for Mr & Mrs Matthews
at Adj. to 56 Macfin Road,
Ballymoney.

T 028 2766 6406

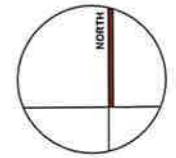

bell
architects
65-67 Main Street
Ballymoney
BT53 6AN

E office@bell-architects.com